

PROLITEC

PERFECTLY SCENTED ENVIRONMENTS

UNIVERSAL HVAC SENSOR field assembly & installation

HVAC Sensor Components

A	ADAPTER TUBING	1"
B	SENSOR CABLE	1
C	SELF DRILLING SCREW	2
D	SET SCREW	1
E	SENSOR	2

Note: follow the UNIVERSAL HVAC instructions before these instructions. This kit is meant to be used in addition to the UNIVERSAL HVAC components, and uses some parts from that kit.

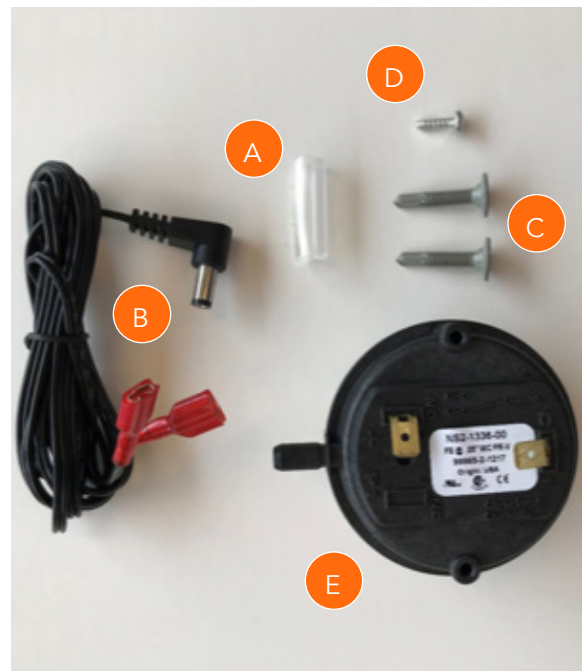

AIRO
BY PROLITEC

Original Instructions

Rev. 2019-10-08

Recommended Tools

1. 3/8" Electric Drill
2. Step Drill Bit 1/8" – 1/2" + capacity
3. #2 Phillips Screwdriver
4. #2 Phillips Screwdriver Bit (for use with Electric Drill)
5. Torpedo Level

Installing the HVAC Sensor

1. Identify the best location for HVAC sensing. **Ensure that no obstacles will interfere with this installation, AND the provided sensor cable can connect to the appliance before proceeding.** Using a step-drill, drill a hole into the HVAC system to create a sensing port that is 1/2" diameter.



2. To create the sensor mounting assembly, **start** the set screw into the injector mount (from the KITHVAC) as shown. Do not allow the screw to poke through into the center at this time.



3. Align the center hole of the mount with the drilled hole. While using a level and maintaining port alignment, ensure that the 'UP' arrows are pointing vertically up, then mark the two holes shown.

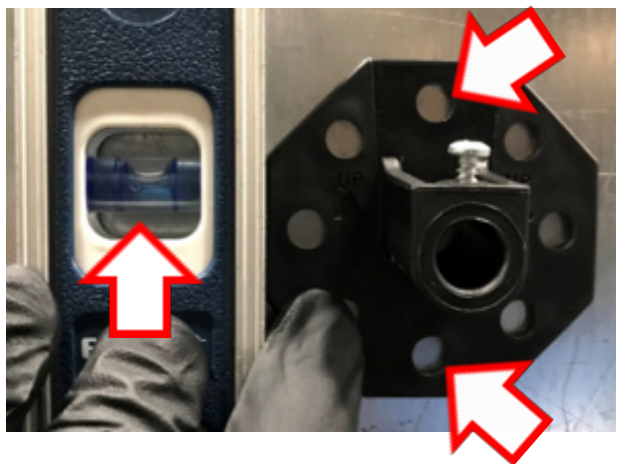

4. Remove the injection assembly and pilot drill the marked mounting holes with a 1/8" diameter drill.

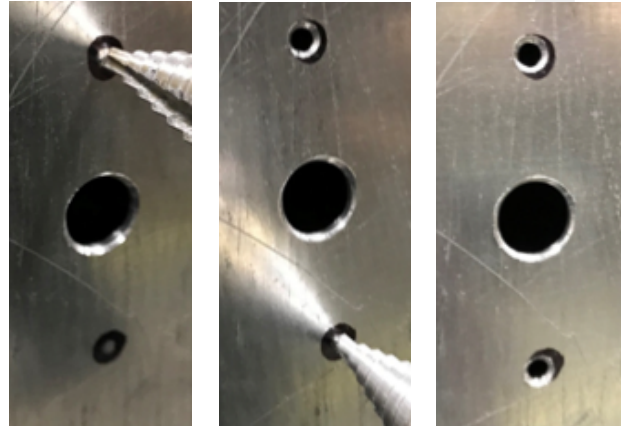

5. Secure the sensor mounting assembly to the HVAC system with the self-drilling screws.

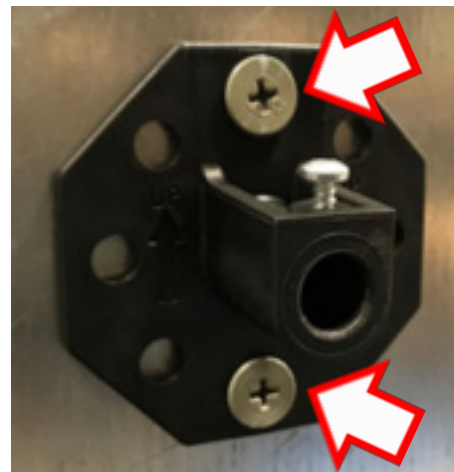

6. Attach the terminals of the sensor cable to the tabs on the terminal side of the sensor as shown:



7. Guide the sensor cable into the slot of the sensor cover (from the KITHVAC) as shown. Align the cover of the sensor over the port as shown, then snap the cover fully into place.



8. Push the adapter tube over the sensor port as shown.



9. Gently guide the adapter tube portion of the sensor assembly fully into the mount as shown.



10. Use a level to ensure that the face marked "THIS SURFACE MUST REMAIN VERTICAL" is vertical.



11. **DO NOT OVER TIGHTEN THE SET SCREW IN THIS STEP, AS IT WILL DAMAGE THE SENSOR!** While maintaining the vertical position, GENTLY HAND TIGHTEN the set screw just enough to hold the sensor in the desired position. The set screw compresses the adapter tube — this compression holds the sensor in place.

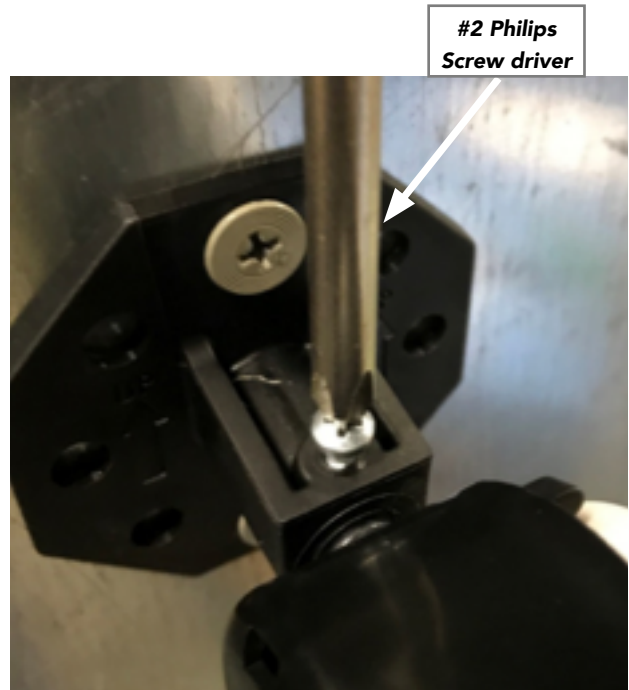

Connecting the Sensor to an AQ1280

1. Remove the access plug from the appliance.



2. Remove the HVAC JUMPER plug and connect the HVAC SENSOR CABLE as shown.



Connecting the Sensor to an AQ580

1. Connect the sensor cable to the appliance to complete the HVAC sensor connection.

Note that the HVAC Sensor is only compatible with an HVAC appliance.

