

Subject: Installation Guide – Environment Stability kit

Date: June 3, 2019

Document Number: INS-VWI-1001 REV 2.0 Installation Guide Environmental Stability Kit

Tools:

Appropriate personal protective equipment (PPE) such as safety glasses and gloves should be used. The following tools are recommended to complete the installation: 7/8" step drill bit, 3/8" drill (cordless is recommended), #2 Phillips Screwdriver (hand), #2 Phillips Screwdriver (for use with drill), Adjustable Pliers

Work Instructions

1. Identify the best location for the **Air Probe** to be installed so that it can pick up processed (heated or cooled) air where the air pressure in the duct is **highest** (typically after the fan). **Ensure that no obstacles will interfere with this installation before proceeding.** Verify that the distance required between the location of the **Air Probe** and the appliance is less than 10 ft. Make sure that the **Air Tube** can be routed to avoid sharp bends, kinks or elevation changes – smoother paths are preferred. Note: if necessary or desired, up to 20' of ½" SCH 40 PVC pipe may be **substituted** for the tubing provided with the kit.

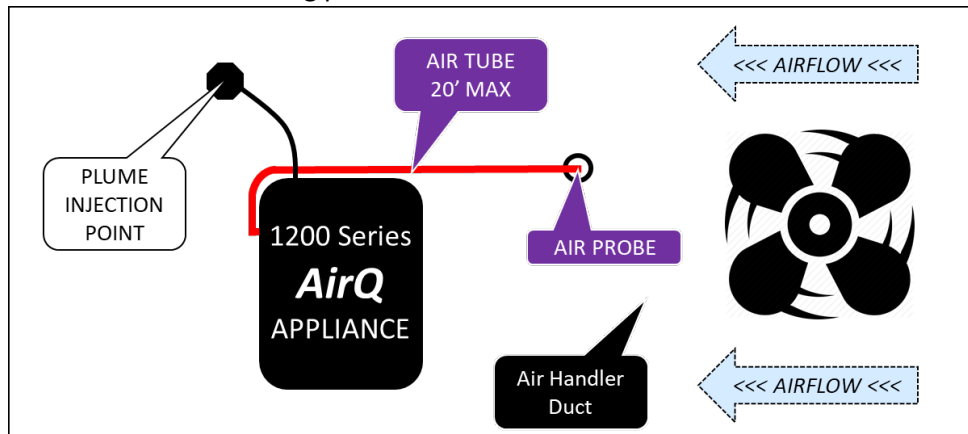

2. Disconnect the appliance from power and, if necessary, remove the cartridge. Remove the access plug from the top left corner of the cabinet as shown:

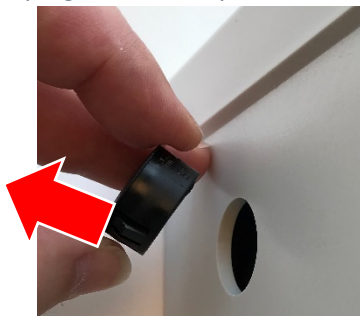

3. Push the tubing over the barbs on the elbow provided:

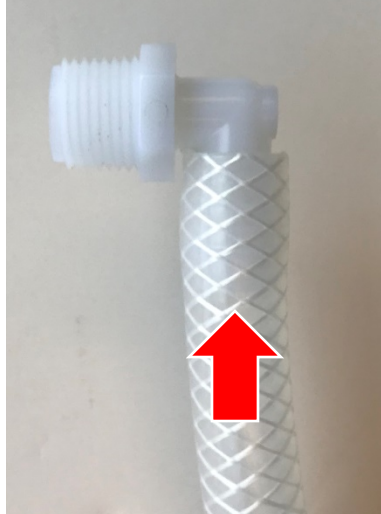

4. Insert the assembly into the access hole in the cabinet ("UP" orientation shown is preferred):



5. Secure the assembly from inside the cabinet with the sealing nut provided. Tighten the nut to ensure that the seal on the nut creates a water tight seal against the interior wall of the cabinet:



- Secure the tubing using the support brackets and screws provided. Route the tubing to avoid sharp bends, kinks or elevation changes. Install a support bracket at least every 2 feet.

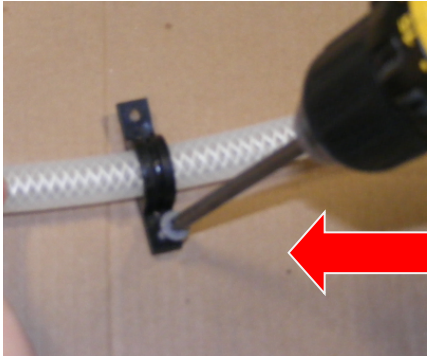

- Place the grommet over the air probe as show below. Drill a 7/8" inch hole diameter into the air duct, and install the probe into the duct.



- Connect tubing to the air probe



- If necessary, replace the cartridge, restore power to the appliance, and resume operation. Clean processed (heated, cooled, filtered) air will now run through the appliance maintaining its performance.