

## HVAC Injector KIT570HVAC Installation Instructions

Rev. 2018-09-04

### COMPONENTS

KIT570HVAC contains the following:

- A. 1 Pitot Tube Device
- B. 1 Cover
- C. 1 Universal Connector
- D. 1 Gasket
- E. 1 Plume Supply Tube
- F. 3 Screws
- G. Port plug

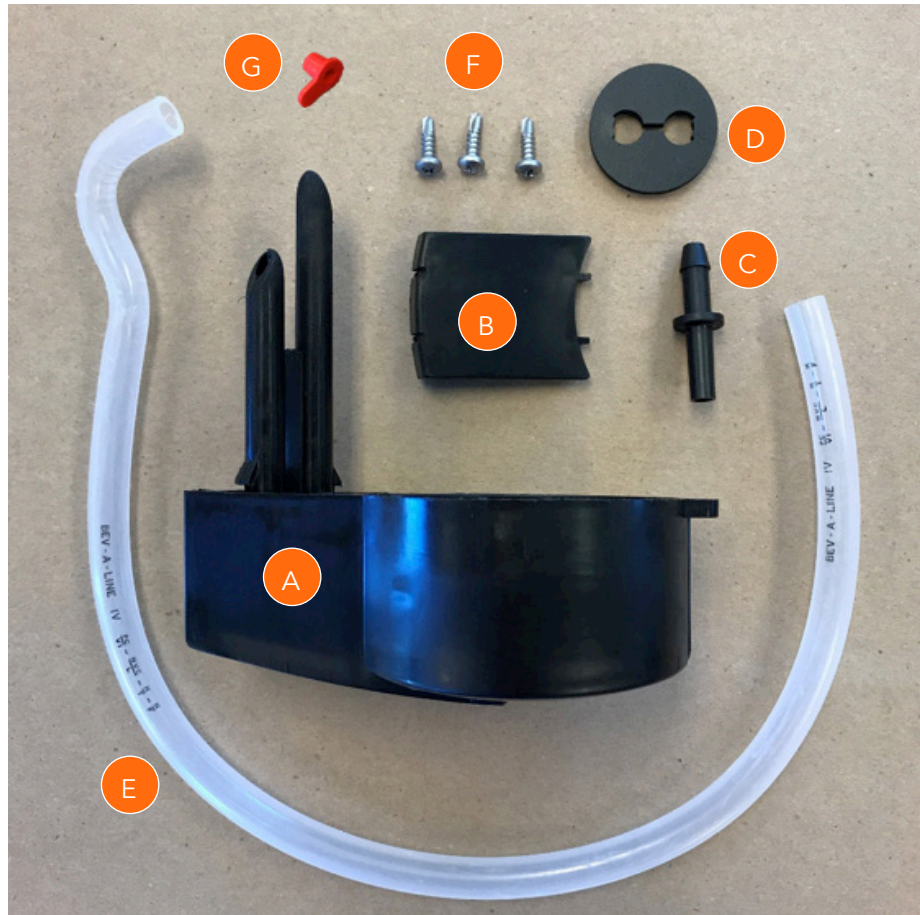

## INSTALLATION OVERVIEW

The Appliance (AQ270, AQ370, AQ380, AQ550, AQ570 or AQ580) is first mounted on a flat vertical surface of an air duct that is free of internal obstructions in the area where the installation is made.

The appliance should be positioned in close proximity to an appropriate power outlet, is easily accessible for service, and meets the spacing requirements shown.

Ensure the PLUME SUPPLY TUBE does not sag, and is not kinked as it smoothly exits the PLUME OUTLET, vertically following the air flow direction to the PLUME INJECTION POINT.

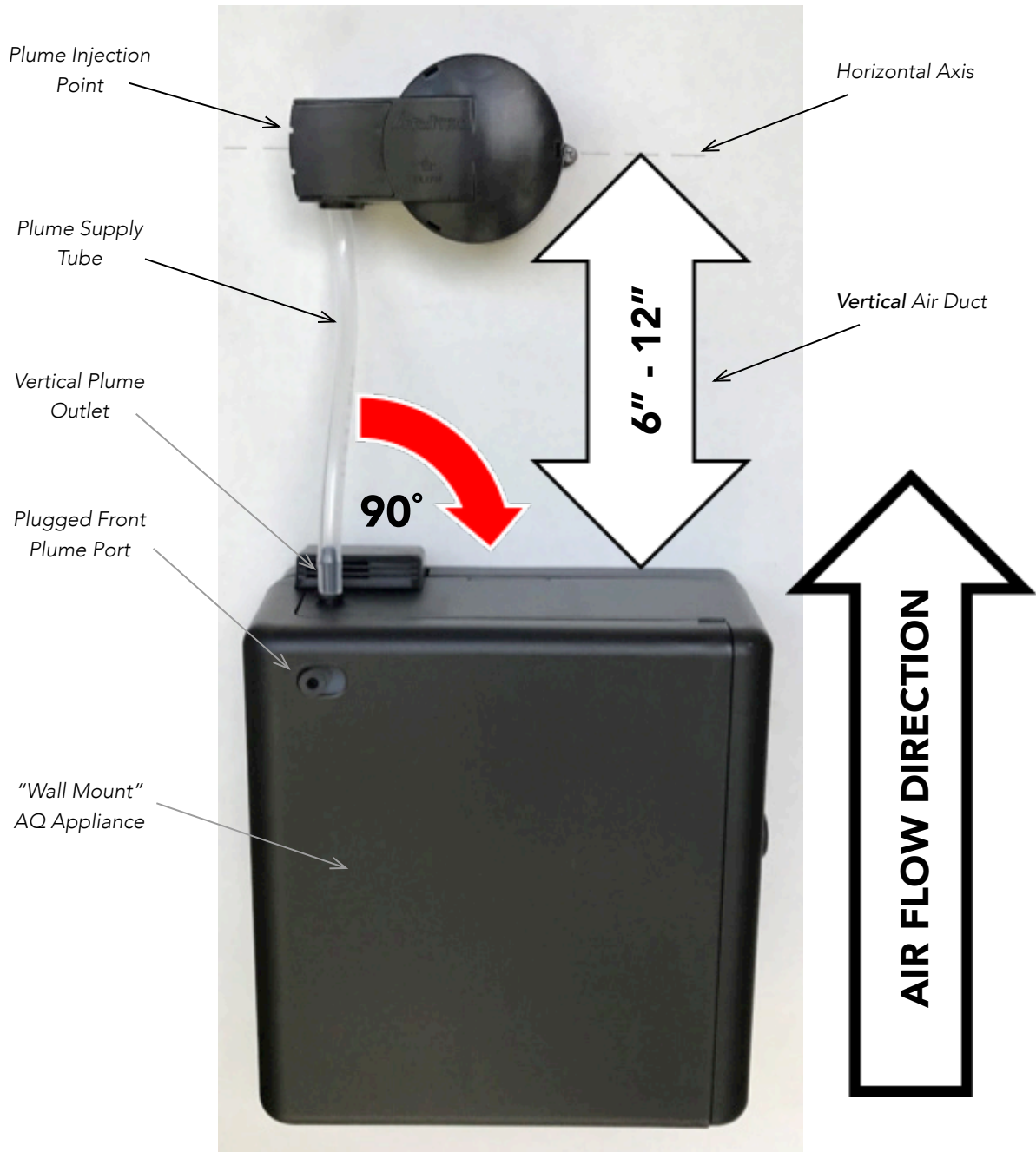

## INSTALLATION

1. Referencing the illustration on the INSTALLATION OVERVIEW page, use a pencil to create the HORIZONTAL AXIS line shown at a distance of 6" - 12" above the already installed appliance (reference wall mounting instructions applicable to the appliance being used). At the point along the HORIZONTAL AXIS line and directly above the PLUME OUTLET, mark the PLUME INJECTION POINT.
2. Drill a 1/8" dia. pilot hole into the duct at this point.



3. Using an appropriate step drill, enlarge the pilot hole to a 7/8" diameter hole.



4. OPTIONAL — using the PORT PLUG (G), plug the port that is not used for this application:



5. Thread the PLUME SUPPLY TUBE (E) through the access slot, and connect it to the TOP LEFT port of the PITOT (A) as shown:



6. Apply the GASKET (D) over the PITOT (A) into place until it is fully seated as shown:



7. Remove the PROTECTIVE FILM from the GASKET to create the finished PITOT ASSEMBLY:



8. Insert the PITOT ASSEMBLY into the 7/8" dia. hole that was drilled into the duct so that the 'FLOW' graphic matches the AIR FLOW DIRECTION. Apply sufficient pressure to the PITOT ASSEMBLY until the SNAPS firmly engage the back side of the duct wall.

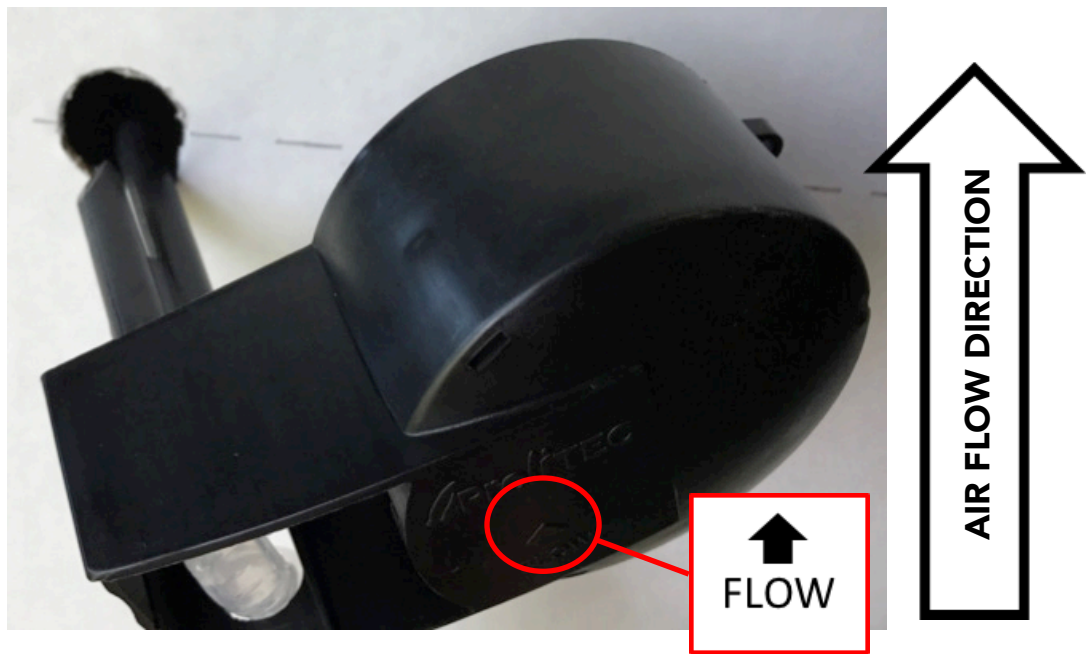

9. Install the (3) self tapping sheet metal SCREWS (F) in the locations shown:



10. Install the COVER (B):



11. Avoiding injury, carefully cut the PLUME SUPPLY TUBE (E) squarely to the desired length for the installation. Then, holding the UNIVERSAL CONNECTOR (C) as shown, insert the barbed end fully into the PLUME SUPPLY TUBE.



12. Fully insert the NON barbed end of the UNIVERSAL CONNECTOR into the vertical PLUME PORT of the cartridge within the appliance. NOTE: this connection must be reversed to change the cartridge!



13. Ensure plug is fully seated in the FRONT PLUME PORT.