



 **Prolitec**

AQ/PS/RZ 1200 & 1200-SOC

Original Instructions

Rev. 2015-05-15



Contents

Chapter 1: About AirQ 1200

Chapter 2: Cartridge Life & Room Size Table

Estimating Cartridge Life

Room-Size Table

Chapter 3: IMPORTANT SAFETY INSTRUCTIONS

Appliance Precautions

Fragrance Precautions

Chapter 4: MOVING AND STORAGE INSTRUCTIONS

Chapter 5: Appliance and Controls

Chapter 6: USER MAINTENANCE

Changing the Cartridge

O-Ring Replacement

Air Filters and Check Valve

Battery Replacement

Chapter 7: OPERATING INSTRUCTIONS

Unit Programming

Setting Scent Intensity

Scent Control

Chapter 8: INSTALLATION: Diffusion via HVAC system

Installation Kit for Appliance

Installation Kit for HVAC System Diffusion

HVAC Pre-installation Checklist

Appliance Positioning

Appliance Installation

Injector Tube Installation

Chapter 9: INSTALLATION: Diffusion via Direct Indoor Fan

Installation Kit for Appliance

Installation Kit for Fan

Pre-installation Checklist

Appliance Positioning

Appliance Installation

Diffusion Fan Installation

Chapter 10: Troubleshooting

Chapter 11: General Care and Customer Support

Chapter 12: Specifications

About AQ/PS/RZ 1200

Welcome to a whole new world of air treatment from Prolitec, the technology leader in air care with scent. The AQ1200 appliance is the most advanced commercial air-treatment system on the market today. It is the world's first fully adjustable commercial air-treatment system engineered to serve indoor spaces.

AQ1200 is a patented, computer-controlled, always-on system capable of maintaining a constant, uniform and controlled level of scent or odor neutralizer.

The AQ1200 converts fragrances and odor control formulations (“Agents”) into ultra-fine droplets for controlled distribution as an aerosol or vapor directly into a room or via the airflow of the HVAC system, either through the central fan unit (CFU) or at suitable locations in the branched ductwork. It is designed for permanent installation on a wall in the area to be treated or integrated with the CFU.

The AQ1200 is managed by an on-board computer that is fully adjustable, enabling intensity settings to match space sizes from 1,800 to 150,000 cubic feet (50-4,200 cubic meters) per appliance. The AQ1200 is programmable, capable of executing 21 distinct start and stop times, repeatable daily or weekly. Utilizing up to 21 programs and the full range of 50 intensity settings allows you to optimize the fragrance levels depending on peak and non-peak occupancy in the space. This new feature can save you money on fragrance AND service visits. Multiple appliances can work together on the same or multiple CFUs to treat the air in the same spaces served by the HVAC. Multiple appliances can work together in the same space.

Typical AQ1200 applications include air treatment to enhance or improve indoor air quality including odor cancelling, and ambient scenting in public spaces such as casinos, malls, hotels, theaters, ballrooms, convention centers, hospitals, retirement and assisted living facilities, schools and restrooms. A single AQ1200 can do both odor control and ambient scenting at the same time.

The AQ1200 with Prolitec odor control formulations and fragrances will cancel a wide range of offensive odors and replace them with pleasant scents available from the Prolitec fragrance catalog or custom developed to meet client requirements.

The AQ1200 works by generating ultra fine, ultra-light droplets approximately 1 micrometer (μm) in diameter. By comparison, a droplet from a typical pressurized aerosol spray can is 50 microns (50000 nanometers) in diameter or 50 times larger than an AQ1200 droplet. In terms of weight and volume of liquid, the comparison is even more dramatic. A 50-micron aerosol droplet is 125,000 times heavier than a 1 μm AirQ droplet.¹ (See also Table 1 below.) This tiny AirQ droplet offers many performance benefits over a conventional aerosol including: completely uniform distribution of the treatment agent; 50 times more exposed surface area; and the absence of any liquid deposits on surfaces such as the interior surfaces in an HVAC system.

AQ1200 is simple to install and program for specific room size, airflow conditions, and desired scent intensity. Minimal maintenance is required beyond the periodic change of the disposable fragrance cartridge, inspection and annual replacement of three O-rings, and a simple wipe down or dusting of exterior surfaces. Once installed in the right location, AQ1200 will outperform any other system, providing completely uniform scent distribution.

The AQ1200's advanced technology creates a scent effect with a smaller quantity of fragrance ingredients than any other method. The chemicals employed in making AQ1200 fragrances are fully compliant with the most restrictive air-quality and inhalation standards. AQ1200 generates no harmful VOCs and uses no ethanol or propellants. Quite simply, used as directed, AQ1200 is the greenest, most eco- friendly way to introduce scent into an interior space with no negative impact on indoor air quality. This is not an accident.

The scientists and engineers at Prolitec are committed to the highest ecological and human safety standards.

This user guide is easy to read. It is also important to read. AQ1200 is a high-performance appliance that, installed and used correctly, will meet the most demanding requirements.

Table 1. Prolitec AirQ Technology vs. Aerosol Spray Can Technology		
Parameter	Prolitec AirQ Technology	Aerosol Spray Can
Droplet Diameter, μm	1	50
Volume per Droplet, μm^3	0.52	65,450
Surface Area per Droplet, μm^2	3	7,854
Relative Volume per Droplet	1	125,000
Relative Weight per Droplet	1	125,000
Number of Droplets per Equivalent Volume	125,000	1
Surface Area/Volume, μm^{-1}	6.00	0.12
Relative Surface Area per Volume	50	1
©Prolitec Inc 2009, 2015		

Cartridge Life & Room Size Table

Estimating Cartridge Life

Estimating how long a cartridge will last and the number of days between services is critical to performing an installation that can be serviced efficiently. This includes determining the number of AQ1200s needed for a space. Please refer to AirQ’s ‘S3 (Sizing, Service & Success) Tool,’ available at [AirQ Tools](#). The chart below can be used as a rough guideline for sizing.

Room-Size Table

	Normal Off-Cycle (NOC)		Short Off-Cycle (SOC)	
Output Level Range	Room Volume Range		Room Volume Range	
	CFT	CM	CFT	CM
1-5	1800-8100	51-229	6000-25000	170-708
6-10	10000-17400	283-492	30000-47100	849-1333
11-15	19300-27700	546-784	51100-66300	1446-1876
16-20	30000-39700	849-1124	70000-83600	1981-2366
21-25	42300-53400	1197-1511	86800-98900	2456-2799
26-30	56300-68600	1593-1941	101600-112000	2875-3170
31-35	71800-812000	2032-2425	114400-123500	3238-3495
36-40	89400-104800	2530-2966	125600-133600	3554-3781
41-45	108900-126200	3082-3571	135400-142300	3832-4027
46-50	130700-150000	3699-4245	143900-150000	4072-4245

These settings are suggested as a starting point. Start on the lower end of the range and adjust after one hour. Fragrance type, room size, number of fresh air changes per hour, temperature, humidity and user preference will determine the final setting. Best practice is to use AirQ’s ‘S3 Tool’ at [AirQ Tools](#).

IMPORTANT SAFETY INSTRUCTIONS

IMPORTANT SAFETY INSTRUCTIONS – SAVE THESE INSTRUCTIONS

Appliance Precautions

1. **WARNING** – When using electric products, basic precautions should always be followed, including the following:
 - Read all the instructions before using the product.
 - Children should be supervised not to play with the appliance.
 - Do not put fingers or hands into the product.
 - The appliance must be operated in an upright or vertical position.
 - The appliance should not be used with the door in the open position. The door is opened only to perform a cartridge or program change.
 - Never put your nose to the output of the AQ1200. Within 12 inches of the output, the fragrance is highly concentrated. The improper inhalation of high concentrations of fragrance may cause irritation including watery eyes, headache, cough and upper respiratory discomfort.
 - This appliance is not intended for use by persons with reduced physical, sensory or mental capabilities, or lack of experience and knowledge, unless they have been given supervision or instruction concerning use of the appliance by a person responsible for their safety.
2. **INSTRUCTIONS PERTAINING TO A RISK OF FIRE, ELECTRIC SHOCK, OR INJURY TO PERSONS**
 - The appliance is built to be plugged into an 110VAC or 220VAC power outlet. Must be used only with the approved and included power supply. The UL and CE compliant power supply converts power to 12V DC to power the appliance. The appliance must only be supplied at Safety Extra Low Voltage (SELV).
 - If the supply cord is damaged, it must be replaced by the manufacturer, its service agent, or similarly qualified persons in order to avoid a hazard.
 - Unplug before cleaning.
 - To reduce the risk of electric shock, the appliance should only be plugged into a properly grounded outlet box. If there is any doubt as to whether an outlet box is properly grounded, a qualified electrician should be consulted.

Fragrance Cartridge Precautions

- Use only AirQ by Prolitec fragrance cartridges.
- Read the Consumer Product Safety Information Sheet and the Material Safety Data Sheet provided with each shipment of Cartridges. Insure that these information sheets are available for review by employees.
- Use latex gloves to handle a Cartridge to avoid the liquid getting on hands. The AirQ fragrances are formulated so as to not be harmful in contact with the skin, but the concentrated nature of the fragrances may make the scent difficult to remove from hands and skin.
- Wash your hands after all contact with Cartridges or fragrance.
- While AirQ Air Treatment Agents do not contain ingredients deemed harmful to the skin, if there is skin contact, wash with soap and water. If there is contact with the eyes, irrigate the eye with fresh water for 5 minutes. If there is any eye irritation, consult a physician immediately.

MOVING AND STORAGE INSTRUCTIONS

1. Remove the cartridge.
2. Unscrew and remove the long round-head screws in the lower corners.
3. Lift the appliance upward, off the mounting posts.
4. Unplug the appliance.
5. Unscrew the mounting plate.
6. Store at -4°F (-20°C) to 158°F (70°C), 5% to 95% humidity

Appliance & Controls

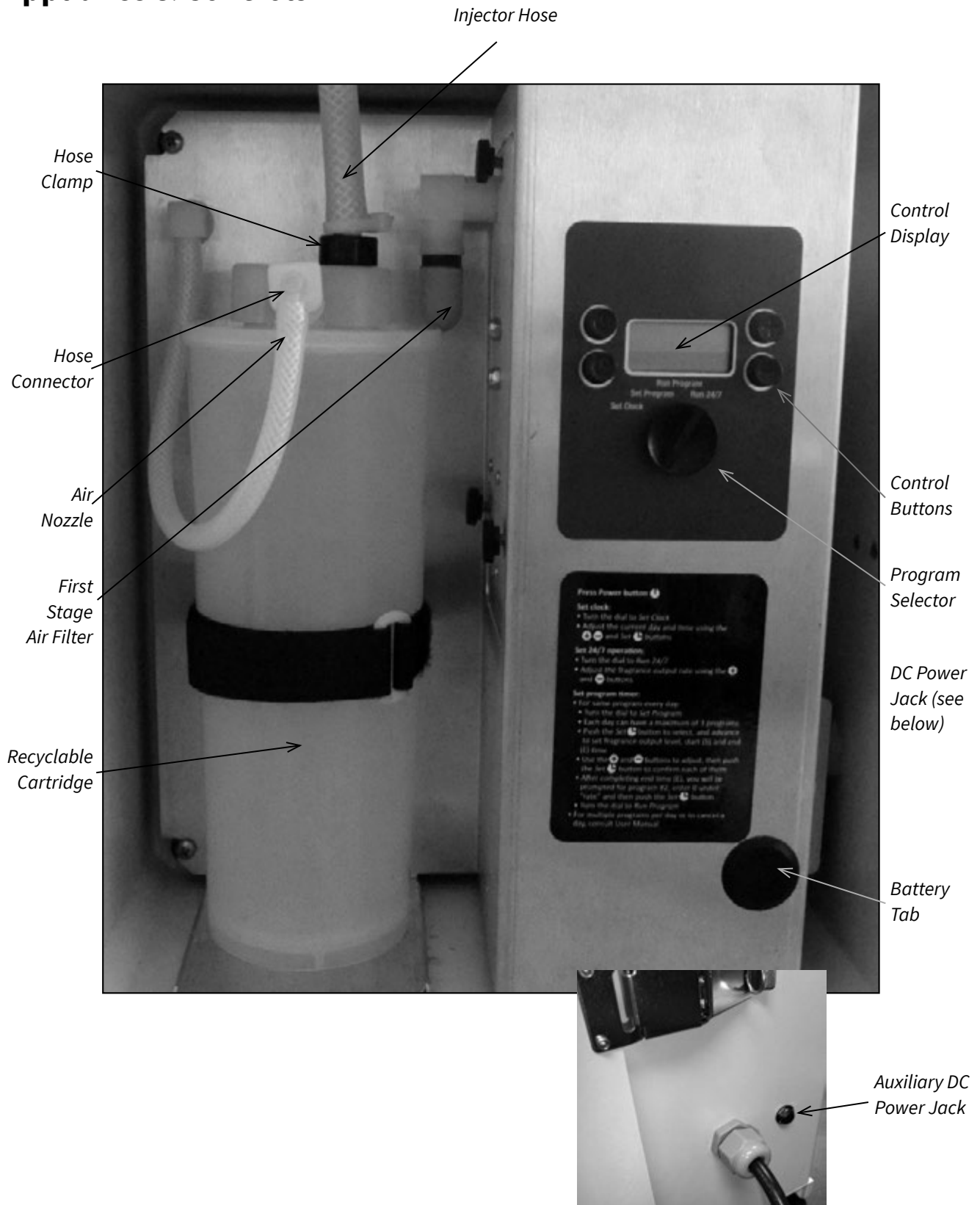

USER MAINTENANCE

Changing the Cartridge

1. Unlatch and open the door to access the cartridge: The door should be opened only to perform a cartridge or programming change. When in use, the door must be closed.
2. Press POWER button to turn appliance OFF.
3. Remove air nozzle (located on the side of the cartridge head) by rotating 90 degrees and pulling towards you. (See [Fig. 1](#))
4. Detach injector hose and hose connector from the cartridge output port (located on the top of the cartridge head). This is done by unscrewing the hose connector from the cartridge output port and pulling out.
5. Remove cartridge from appliance enclosure.
6. Install new cartridge, place and tighten hose connector firmly on cartridge output port.
7. Insert air nozzle and rotate the handle 90 degrees until secured (by stem retaining tab on cartridge head). (See [Fig. 2](#))
8. Turn appliance ON. Verify that the plume is not escaping inside the appliance and that all connections are tight. Close the door when complete.

Fig. 1



Fig. 2

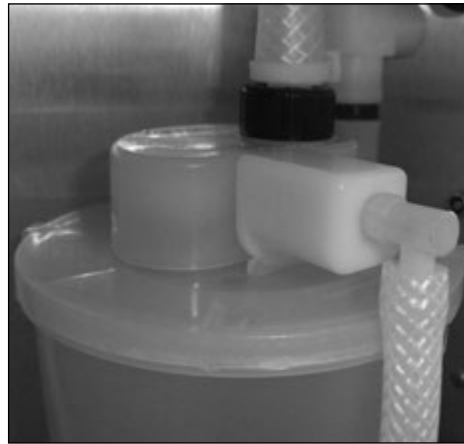

O-Ring Replacement (each year or as needed)

1. Replace the air nozzle's three O-rings (PN 8212) if worn or damaged. Replace as needed and/or each year for preventative maintenance.
2. If there is any fragrance that leaks during the cartridge installation, clean it carefully with a paper towel and some ethanol or another alcohol.

Air Filters and check valve (every 6 months or sooner depending on use)

AQ1200 is equipped with two stages of air filtration and a check valve system.

The first stage is a sintered filter (PN 10417). It can be unscrewed and washed with clean water as needed. Replace every six months.

The second stage filter (PN 5251) collects fine dust. Replace every 6 months or sooner depending on use. It is accessible behind the air pump panel. A layer of black dust on top of the filtering media is a sign that the filter should be replaced. To replace it, unscrew the 3 knobs to open the panel and exchange the filter after pulling off the rubber tubing from both sides of the filter. Note the small triangle showing the normal air flow direction and position filter accordingly as shown below.

The check valve (PN 10200) should be replaced every six months. It is also located behind the panel. Note the position of the check valve. Replace check valve accordingly as shown below.

Reinstall the panel and screw the three knobs back in place being careful not to strip the threads. The screws should align and go in easily.

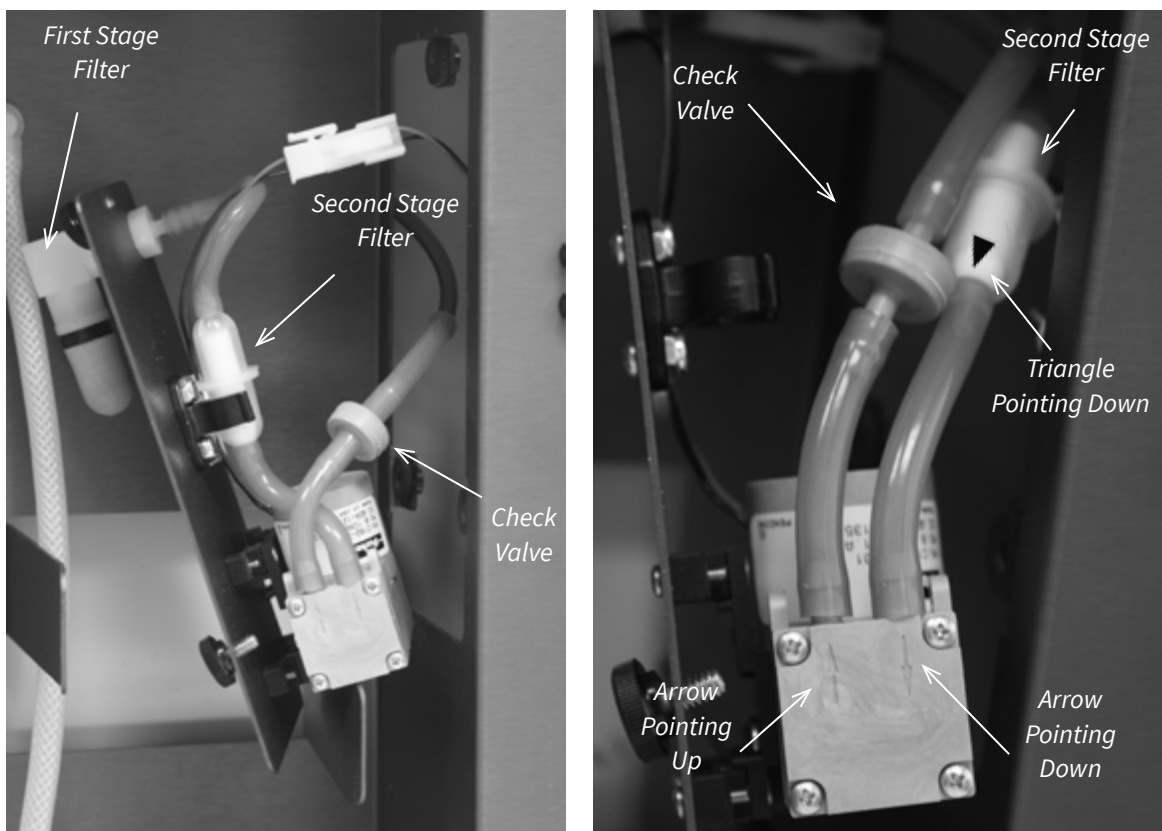

Battery Replacement (approximately every two years)

(Requires 3 Volt CR2032 Lithium Battery, PN 8111)

1. Unlatch and open the door to access the enclosure.
2. Using a pair of tweezers or needle-nose pliers, remove battery from the center opening of the battery grommet. The battery is located on the lower front corner of the silver bracket.
3. Insert the new CR2032 battery. The positive side of the battery should face your right while looking at the front of the appliance. The battery will have a + or – marking on a side.



NOTE: The battery is necessary to safeguard your program and to ensure operation will resume automatically even after several days of a power interruption. The battery should be replaced at least every 2 years for proper reliable system operation.



OPERATING INSTRUCTIONS

Unit Programming

1. Unlock and open the door
2. Turn on the power by pressing ON/OFF button in the upper left corner of the control panel.
3. Set the Clock
 - Turn the dial to **Set Clock**. The day-of-week icon will blink.
 - Adjust the day forward or backwards using the +/- buttons on the right side of the control panel.
 - Press the **Set** button on the lower left corner of the LCD display. The time will blink.
 - Adjust the time forward or backwards using the +/- buttons. AM or PM is indicated on the right side of the time digits.
4. 24/7 Mode
 - If you want the AQ1200 to run continuously -7 days a week, 24 hours a day 7 Days a week turn the dial to **Run 24/7**. If not, skip to Step 5.
 - You can adjust the fragrance intensity level (1 to 50) using the +/- buttons. Refer to [Setting Scent Intensity](#) for the intensity level to set.
5. Set multi-program timer
 - Turn the dial to **Set Program**. The Program icon comes on.
 - The day-of-week icons will all blink, indicating you are selecting all days with the same program. If you want to program a specific day, use the +/- buttons to select the day. You can set maximum of 3 on/off programs same for every day or individually for each day. After selecting the day, press the **Set** button to advance.
 - Now the “1” icon is turned on to indicate you are setting program 1. The Rate digits blink to prompt you to set the rate. You may set to any value between 1 to 50, or set to 0 to disable the program. Press the **Set** button to advance.
 - If you set the rate to 0, then the current and subsequent programs are all disabled. For example, if the rate for program 2 is 0, then program 2 and 3 are disabled.
 - If you set a non-zero rate, then the rate digit changes to “S” to indicate start time. The hour digit should blink to prompt you to set the start hour. Use the +/- buttons to set the hour. Then press the **Set** button to advance and set the minute. Press the **Set** button to advance.
 - The rate digit now changes to “E” to indicate you are setting the end time. Use the +/- buttons to set the end time. Press the **Set** button to advance to the next program.
 - Program icon 2 should now turn on. Use the +/- and **Set** buttons to set the start and end times for program 2 and then for program 3. Note that if you need only 1 or 2 programs for the day, you simply disable the subsequent programs by setting its rate to 0.
 - After setting the programs, turn the dial to **Run Program**.

HINT: To set same programs for Monday to Friday, you may set the programs for every day first and then disable Saturday and Sunday. You may review the programs by doing the same as in programming. Just beware not to accidentally set the every day programs as this will also set and change the programs of all the days.

Setting Scent Intensity

1. Consult the [Room Size Table](#), which provides a setting for the size in cubic feet (length x width x ceiling height) of the space you are treating. Use the indicated intensity setting as a starting point from which you can increase or decrease to taste. Number of fresh air changes per hour and user preference will affect settings.
2. Press the power button on. Turn the dial to **Program** and set the intensity level with the +/- keys. You will see the level numbers (1 to 50) on the right side of the screen.

Hint: There are many variables to finding the scent level that works: size, airflow, number of fresh air changes per hour, number of people in the space and, most of all, user preferences. Experiment with different levels until you are satisfied. Utilize the S3 Tool.

Scent Control

If you followed the [Room-Size Table](#) or S3 Tool, you have set AQ1200 to the low end of the range for your room size. If after one hour you feel the scent is not detectable, increase the setting by about 10%. For example, if your start setting was 20, increase it by 10%, or to setting 22. Keep increasing until you and others in the space can detect a slight scent throughout the space.

The Last Step

1. Set the appliance to either **24/7** or **Run Program**.
2. Make sure the power is on. The blue light will show through the button.
3. Close and lock the door, storing the key in a known place.

INSTALLATION: Diffusion via HVAC System

Installation Kits

Installation Kit for Appliance (included)

1. One (1) AQ1200 appliance (not pictured) with:
2. Four (4) drywall anchors for mounting in drywall
3. Four (4) lead anchors for mounting in concrete
4. Four (4) screws and (4) washers for mounting in drywall and concrete
5. Four (4) #10 self-tapping sheet metal screws for mounting in sheet metal
6. Plume connector: A: (1) Tubing assembly; B: (1) Connector; C: (2) Washers; D: (1) Nut; E: (1) Cable Tie



Installation Kit for HVAC System Diffusion (included)

1. One (1) Prolitec injector tube for diffusion into HVAC system
2. Three (3) #10 self-tapping sheet-metal screws for mounting the injector tube in sheet metal
3. Five (5) feet of injector hose



HVAC Pre-installation Checklist

This checklist should be completed before the install date.

1. Confirm the area to be targeted for air treatment.
2. Determine the Air Handling Unit or duct that serves the target area.
3. Make sure the AHU does not use an open gas flame.
4. Find and mark the optimal insertion point for the Injector Tube. (See “Appliance Positioning” below)
5. Find and mark the exact location for placement of the appliance. (See “Appliance Positioning” below)
6. Note the distance between the insertion point and the proposed appliance location. (NEVER MORE THAN 5 FEET and there should NEVER be a LOW POINT in the hose run.)
7. Determine and mark the location for the 110 or 220V AC power outlet (NEVER DIRECTLY BELOW THE appliance).

Appliance Positioning

It is important to find an insertion point where the plume output will be smoothly drawn into and mixed with the airflow. This usually means those parts of the AHU where the static pressure is negative. Ideal locations include:

- Before the supply fan with injection through the wall of the AHU. Positioning immediately before the fan and after the coils if possible or in the mixed air chamber.
- Behind the blower with the whole appliance mounted inside the AHU in the mixed air chamber.
- Outside the AHU in the Supply air duct.

Best practice when installing in an AHU is to place the injector tube after the heating and cooling coils. If this is not possible, the Plume output can pass over hot water, steam, chilled water, and DX coils.

Open gas flames should absolutely be avoided. If installation must be over gas heated coils or open gas flames, contact Prolitec Technical Support.

The best location for the Appliance is below the injector tube ([Fig. 15](#)). The injector hose should be run upward as short a distance as possible and NEVER MORE THAN 3 FEET. If an upward injector hose run is not possible, care should be taken support the hose to prevent sagging or any low spot in the run to avoid any possibility of condensation and liquid collection which will block the plume output. The injector hose is prone to stretching, so support points should be placed every 6 inches on horizontal runs. Give the hose a slight upward slant along its run (See [Fig. 16](#)). The hose must not be run horizontally. A strong tape (such as Venture tape) may be used to support short runs. The hose may be run through PVC pipe for longer distances.

Fig. 15

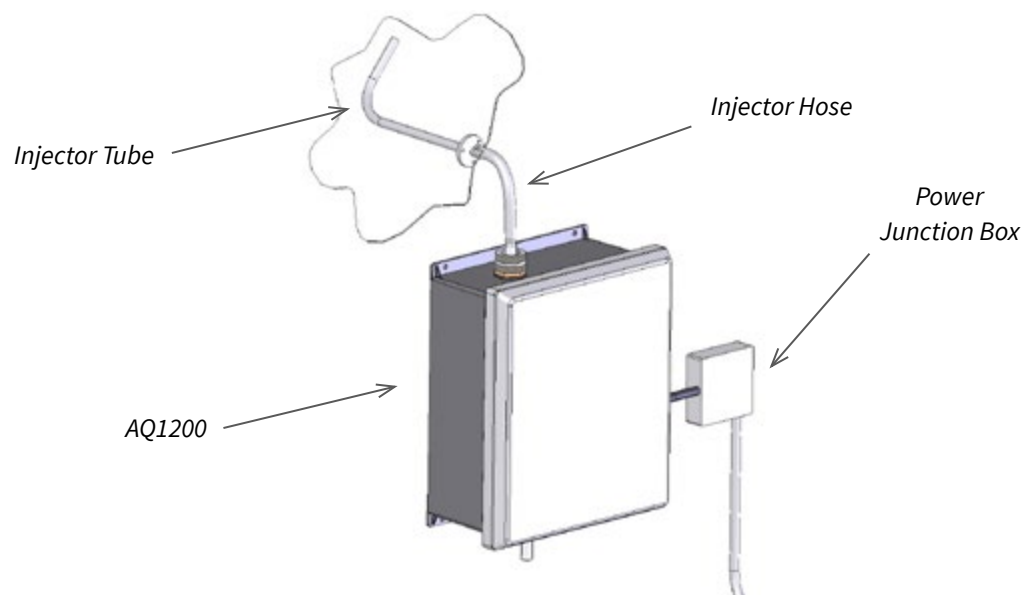
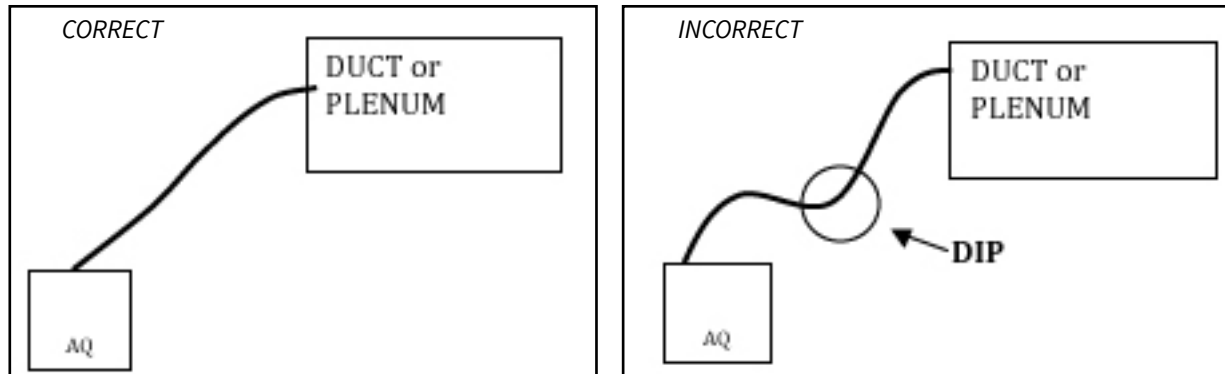

Fig. 16



Appliance Installation

1. The appliance is wall-mounted. Place the appliance onto the desired location on the wall or AHU and ensure that it is level.
2. Fasten the appliance to the wall or AHU using necessary screws.
3. Connect the power cord to a junction box or attach an AC plug to the cord and connect to a nearby outlet. Open the enclosure door and unscrew the aluminum cap of the waterproof collar located on top of the appliance enclosure. Remove and set aside the grommet ([Fig. 1](#)).
4. Assemble the Plume Connector:
 - Insert washer and insert assembly, threaded side first, through hole on top of the appliance ([Fig. 17](#)).
 - Insert another washer and secure with nut. Use pliers to ensure a watertight seal ([Fig. 18](#)).
 - Push the tubing assembly over the barbed fitting ([Fig. 19](#)).
 - Important: Secure with cable tie ([Fig. 20](#)).



Fig. 17



Fig. 18



Fig. 19

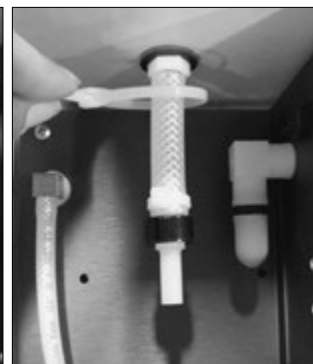

Fig. 20

Injector Tube Installation

The injector tube is installed directly into the AHU or ductwork. Its orientation can be adjusted relative to airflow.

- For installations into the negative/suction side of the AHU fan, orient the tube with the elbow pointed upwards, so that any plume condensation will drip back down the tube.
 - For installations after the supply fan, such as in a supply duct, it is necessary to configure and orient the Injector Tube to obtain a good aspiration of the output into the air stream. The injector tube should be pointed in the direction of the airflow and inclined approximately 45° upward. Turbulence in the airflow can prevent even aspiration of the plume. It is best to place the tube in a straight section of duct, and far away from any turns, branches, or cross-section changes as practical, and not immediately after the supply fan.
1. At the insertion point, drill a hole using a ½” drill bit.
 2. Insert the Injector Tube through the hole.
 3. Find an orientation of the injector Tube that appears to produce a good draw of air into the end of the barb.
 4. Fasten the flange using the three #10 sheet metal screws.
 5. Turn the appliance on and verify that a plume is produced.
 6. Before attaching the Injector hose to the injector, verify that the plume can flow easily through the injector. This can be done by placing the end of the hose ½ inch away from the injector and verifying that the plume is being drawn in (a flashlight will make the plume easier to see). If the plume does not rise into the hose, adjust the orientation of the Injector Tube until aspiration is achieved.
 7. Attach the Injector hose onto the hose barb of the Injector Tube.

For Cartridge Installation – See “[Changing the Cartridge](#)”

INSTALLATION: Diffusion via Direct Indoor Fan

(Product# AQ1200-FAN)

Installation Kits

Installation Kit for Appliance (included)

1. One (1) AQ1200 appliance (not pictured) with:
2. Four (4) dry wall anchors for mounting in drywall
3. Four (4) lead anchors for mounting in concrete
4. Four (4) screws and (4) washers for mounting in drywall and concrete
5. Four (4) self-tapping sheet metal screws for mounting in sheet metal
6. Plume connector: A: (1) Tubing assembly; B: (1) Connector; C: (2) Washers; D: (1) Nut; E: (1) Cable Tie



Installation Kit for Fan (accessory sold separately)

1. One (1) Prolitec Diffusion fan and cable for direct indoor diffusion
2. Three (3) drywall anchors for mounting fan onto dry wall
3. Three (3) lead anchors for mounting in concrete
4. Three (3) screws for mounting in drywall and concrete
5. Five (5) feet of small cable raceway for fan cable
6. Five (5) feet of OD injector hose



Pre-installation Checklist

This checklist should be completed before install date.

1. Confirm the area to be targeted for air treatment.
2. Confirm the general direction of ambient air flow in the area and position the machine so that the plume will be more evenly distributed and carried by the natural air flow.
3. Determine the number of machines required, which is the total cubic feet to be served divided by a maximum of 150,000.
4. Based on step 2, determine the wall positions for installation, keeping in mind that the Appliance requires 110/220V AC.

Appliance Positioning

It is important to find a location that is easily accessible for service and cartridge refills.

Appliance Installation

1. The appliance is wall-mounted. Place the appliance onto the desired location on the wall and ensure that it is level.
2. Fasten the appliance to the wall using the necessary anchors, screws and washers provided.
3. Open the enclosure door and unscrew the aluminum cap of the waterproof collar located on top of the appliance enclosure. Remove and set aside the grommet ([Fig. 1](#)).
4. Assemble the Plume Connector:
 - Insert washer and insert assembly, threaded side first, through hole on top of the appliance ([Fig. 17](#)).
 - Insert another washer and secure with nut. Use pliers to ensure a watertight seal ([Fig. 18](#)).
 - Push the tubing assembly over the barbed fitting ([Fig. 19](#)).
 - Important: Secure with cable tie ([Fig. 20](#)).
5. Assemble hose and hose connector together ([Fig. 2](#)). Be sure to leave approximately 1/8 of an inch clearance between the top of the cartridge hose connector and the end of the hose. Then secure with clamp, ensuring that the hose connector is still free to rotate.
6. Connect the power cord to a junction box or connect AC plug to a nearby outlet.

Diffusion Fan Installation

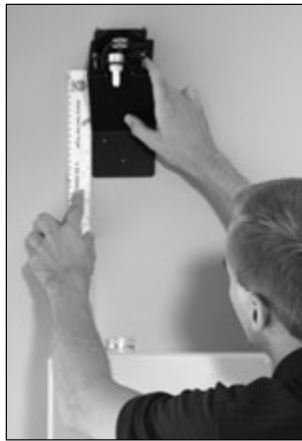

Fig. 3



Fig. 4



Fig. 5

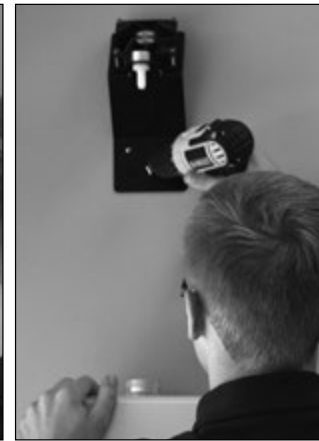

Fig. 6

1. The diffusion fan is positioned directly above the appliance hose output port located on the top left of the appliance but no more than 4-1/2 feet above it. ([Fig. 3](#))
2. Use the diffusion fan assembly as a template to mark the location of the mounting holes. ([Fig. 4](#))
3. For installation on drywall, drill the 3 anchors into drywall and install the 3 screws to secure the diffusion fan to the wall. Use the metal screws provided for installation on sheet metal or appropriate fastening hardware for other wall surfaces. ([Figs. 5 & 6](#))
4. Verify cable connection with diffusion fan. ([Fig. 7](#))
5. Measure the length of cable raceway needed and cut to length using a pair of scissors or a cutting blade ([Fig. 8](#)). Fold into an “L” shape and peel off liner ([Fig. 9](#)). Fasten adhesive side to the wall between appliance and Diffusion Fan assembly.

Fig. 7





Fig. 8



Fig. 9

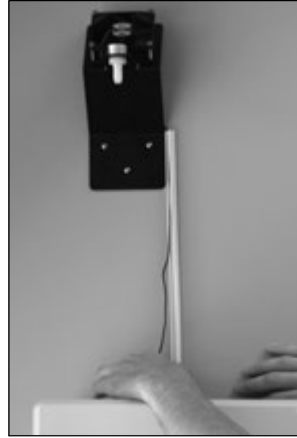

Fig. 10

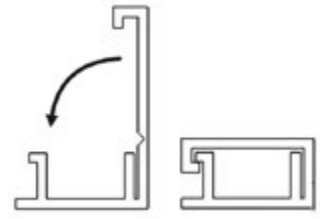

Fig. 11

6. Run Diffusion Fan cable inside the raceway ([Fig. 10](#)), fold the raceway into a square and snap the raceway cover closed. ([Fig. 11](#)) If needed, use a flat-head screw driver to push in the side wall of the cable raceway.



Fig. 12



Fig. 13



Fig. 14

7. Insert cable connector into jack located on the right side of the appliance. ([Fig. 12](#))
8. Extend the hose from appliance toward the diffusion fan hose barb, cut to proper length ([Fig. 13](#)) and secure to the hose barb of the diffusion fan assembly. ([Fig. 14](#))
9. Turn the APPLIANCE on and verify that a plume is produced.

Troubleshooting

Condition	Causes	Solutions
Power light off.	The Appliance is not plugged in or the plug has no power	<p>Make sure the power connection is operational.</p> <p>Verify that the power button light is blue when pressed.</p>
Unit does not start automatically after a power interruption.	Back-up battery not operational	<p>Verify the protective yellow battery tab has been removed.</p> <p>Verify the battery is positioned with the positive side facing the right.</p> <p>Replace the back-up battery.</p>
The fragrance cannot be detected when coming into the treated area from an untreated area.	The output rate is too low or there is an insufficient number of appliances serving the space.	<p>Increase the output rate by one or two settings and evaluate detection in 30 minutes. Repeat as needed. If consumption requires cartridge change more frequently than each month, install an additional appliance.</p>
	The O-Rings on the stem that fits into the head may be worn out and causing an air leak.	<p>Replace the O-Rings by removing the worn one with a pointy tool and rolling on the new ones</p>
Fragrance intensity is stronger than just detectable.	The output rate is too high.	<p>Lower the output rate in increments of one or two settings or down to the starting rates suggested in the room size chart.</p>
The power light is on but there is no output or you cannot hear the compressor in the appliance.	You are in an “OFF” period in the Timer cycle.	<p>Simply wait a few minutes for the appliance to cycle on. If the real problem is that the scent cannot be detected, increase the output rate as instructed above.</p>

Condition	Causes	Solutions
<p>The power light is on and the compressor can be heard but no fragrance detected.</p>	<p>The output tube may be blocked.</p>	<p>Remove the hose from the output tube leaving the Cartridge in place in the appliance. Turn the appliance on so you can hear the compressor. Use a flashlight to observe the top of the output head for a plume of droplets. If you can see the plume then the blockage may be in the hose or the injector tube into the HVAC. Check these. If there is no plume something is blocking the output tube. Check and remove it.</p>
	<p>The air intake may be blocked.</p>	<p>Another method for clearing obstructions is, while the appliance compressor is running, block the output tube with a finger for a few seconds and then open it by removing your finger.</p>
	<p>The O-Rings on the stem that fits into the head may be worn out and causing an air leak.</p>	<p>Replace the O-Rings by removing the worn one with a pointed tool and rolling on the new ones.</p>
<p>You detect the fragrance when entering the room but after a while you no longer notice it.</p>	<p>This is called olfactory adaptation and is normal.</p>	<p>Leave the area for 5 to 10 minutes. Come back inside, you will smell the fragrance once again. Do not hesitate to repeat this process every time that you doubt the presence of the fragrance in the area.</p>

General Care and Customer Support

- Do not drop AQ1200 on the floor. Do not drop it in or position it near an open basin of water.
- Do not paint or otherwise try to alter the color of the outer cover.
- Always keep the cap and plug on cartridges when stored outside of the AQ1200.
- Do not operate AQ1200 in very dusty areas that may cause the air intake to clog.
- Do not move or transport an appliance with a cartridge installed.
- Please call Prolitec Customer Service at 866.387.4333 for return shipping instructions or questions.

Specifications

Dimensions

AQ1200 Appliance 15 1/2" x 13 3/8" x 6 3/4" (39.4 cm x 34.0 cm x 17.2 cm)

Weight

13.7 lbs (6.2 kg) with a full 1250mL cartridge

Power Supply

Input — 100 – 240V AC at 0.6A

Frequency — 50/60 Hz

Protection — Switching power supply

Internal Power — 12V DC at 1.5 A

Battery — Lithium 3V, #CR2032

Approvals

UL/CSA listed Power Supply

Working Temperature

0° to 40° C

Working Humidity

85% or less

Liquid Capacity

1250mL cartridges

Service Area

Up to 150,000 cu. ft. (4245 m³) served

Prolitec, Incorporated
1235 W. Canal Street
Milwaukee, WI 53223
1-866-387-4333

www.airq.com

All contents © 2015 Prolitec, Inc.