

# Air/Q™ 210

User Guide



*Revised 15 Jan. 2013*

 **Prolitec**



# Table of Contents

About Air/Q™ 210.....	2
Unpacking .....	3
Installation .....	5
General.....	5
Estimating Cartridge Life .....	6
Room-Size Table.....	7
Appliance Location .....	7
Wall-Mounting Air/Q 210 .....	8
Starting Up .....	15
Features and Controls .....	15
Setting Up the Cartridge.....	16
Programming the Appliance .....	18
Setting Scent Intensity.....	19
Scent Control.....	20
The Last Step.....	20
Maintenance.....	20
Cartridge Change.....	20
Cartridge Change Maintenance Checklist Items .....	21
Changing an Appliance.....	22
General Care .....	22
Applications.....	23
Ambient Settings .....	23
Scent Media.....	24
Odor Control .....	25
Aromatherapy and Performance Scenting .....	26
Precautions .....	27
Appliance Precautions.....	27
Frequently Asked Questions (FAQs).....	28
Specifications.....	31

## About Air/Q™ 210

---

Welcome to a whole new world of air treatment from Prolitec, the technology leader in air care with scent. The Air/Q 210 appliance is the most advanced commercial air-treatment system on the market today. It is the world's first fully adjustable commercial air-treatment system engineered to serve indoor spaces ranging in size from 200 to 30,000 cubic feet (10 to 850 cubic meters).

Air/Q 210 is a patented, computer-controlled, always-on system capable of maintaining a constant, uniform and controlled level of scent or odor neutralizer. The basic technology of Air/Q 210 has been tested and proven in demanding commercial environments such as retail stores, malls, hotel lobbies and other public spaces where scent is used to enhance the environment, market a product, or erase an odor.

Air/Q 210 uses a single board computer to make fine adjustments to scent intensity and tailor performance to room size and conditions. A quick-change disposable and recyclable fragrance cartridge changes out in a matter of seconds rather than minutes.

The classic design blends well into any environment. Air/Q 210 comes standard in Textured True Black or Eggshell White. On special order, Air/Q 210 can be supplied in any color. Air/Q 210 can also be concealed in a fixture, cabinet or behind a wall-mounted shroud to match any interior design.

Air/Q 210 can use 100V to 240V power sources and comes complete with power plugs for every country. Air/Q 210 is designed to be mounted on a wall with a flush-mounted power source behind it or, on special order, it can be configured for attachment to ceiling track-lighting systems, which act as both a source of power and a method of attachment.

Air/Q 210 is simple to install and program for specific room size, airflow conditions, and desired scent intensity. Minimal maintenance is required beyond the periodic change of the disposable fragrance cartridge, inspection and annual replacement of two o-rings, and a simple wipe down or dusting of exterior surfaces. Once installed in the right location, Air/Q 210 will outperform any other system, providing completely uniform scent distribution.

## About Air/Q™ 210

---

Air/Q 210 is green and eco-friendly. Air/Q 210's advanced technology creates a scent effect with a smaller quantity of fragrance ingredients than any other method. The chemicals employed in making Air/Q 210 fragrances are fully compliant with the most restrictive air-quality and inhalation standards. Air/Q 210 generates no harmful VOCs and uses no ethanol or propellants. Quite simply, used as directed, Air/Q 210 is the greenest, most eco-friendly way to introduce scent into an interior space with no negative impact on indoor air quality. This is not an accident. The scientists and engineers at Prolitec are committed to the highest ecological and human safety standards.

This User Guide is easy to read. It is also important to read. Air/Q 210 is a high-performance appliance that, installed and used correctly, will meet the most demanding requirements.

## Unpacking

---

Remove Air/Q 210 from the container. The following items should be included:

1. Air/Q 210 Appliance
2. Power Supply
3. Two Keys
4. Wall-mounting kit containing dry-wall anchors and screws (4 each) and a mounting bracket
5. Cartridge Removal Tool
6. One plastic output-extension tube – clear for white appliance, blue for black appliance

# Unpacking

---

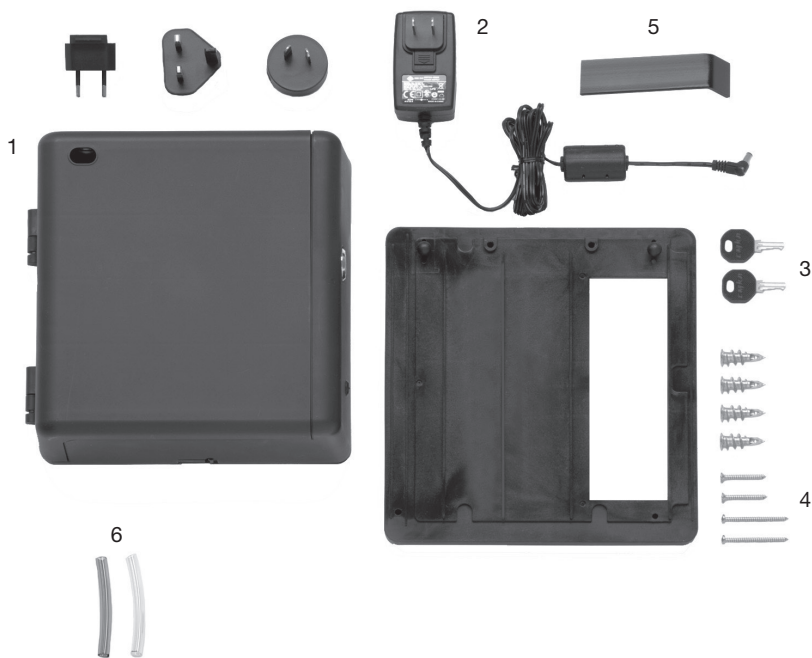

# Installation

---

## General

1. **Location:** Air/Q™ 210 is designed for permanent installation on wall surfaces over a 110 to 240V plug or hard-wired power source and located well above and out of human reach. Air/Q 210 is NOT a portable or table or shelf-top unit.
2. **Service Area:** The service area range of Air/Q 210 is from 200 to 30,000 cubic (10 to 850 cubic meters). Of course this can vary significantly depending on airflow, number of fresh air changes per hour, temperature and humidity. Air/Q 210 can be adjusted from 1 to 50 to accommodate these variations.
3. **Configurations:** Air/Q 210 is available in two configurations: wall-mount and track-mount. Wall-mount (see Figure 1) has a 110-240V power source and plug in the back of the appliance, and must be placed over the power source. Special power supply adapters and plugs are provided. Track-mount (Air/Q 210T) is designed for attachment to a ceiling track-light system (see Figure 2).
4. **Colors:** Air/Q 210 comes standard in black or white, and can be special ordered in any color.



Figure 1



Figure 2

# Installation

---

## Estimating Cartridge Life

Estimating how long a cartridge will last and the number of days between services is critical to performing an installation that can be serviced efficiently. This includes determining the number of Air/Q™ 210s needed for a space. Here is the formula and table for making this determination.

The variables are as follows:

L = Cartridge Life in Days

C = Cartridge Size in milliliters

S = Intensity Setting

H = Operating Hours per Day

D = Days between services

Q = Number of Air/Q 210s

Days Life for Air/Q 210

$$L = C / ((S/50) * (H))$$

You can vary any of these values except L.

For example: a 175 ml cartridge in an Air/Q 210 operating for 12 hours a day on setting 35 would last for 21 days.

The Intensity Setting for one Air/Q 210 can be roughly estimated using this Room-Size Table (see following page).



## Installation

---

### Room-Size Table

Output Level Range	Room Volume Range in CFT	Room Volume Range in m <sup>3</sup>
1 thru 5	200 – 800	6 – 23
6 thru 10	1,000 – 1,700	28 – 48
11 thru 15	1,900 – 2,800	54 – 79
16 thru 20	3,000 – 4,000	85 – 113
21 thru 25	4,200 – 5,300	119 – 150
26 thru 30	5,600 – 6,800	159 – 193
31 thru 35	7,200 – 8,600	204 – 244
36 thru 40	8,900 – 10,500	252 – 297
41 thru 45	10,900 – 12,600	309 – 357
46 thru 50	13,100 – 15,000	371 – 425

These settings are suggested as a starting point. Start on the lower end of the range and adjust after 15 minutes. Room size, number of fresh air changes per hour, temperature, humidity and user preference will determine the final setting.

### Appliance Location

1. Placement of Air/Q™ 210 appliance is the KEY TO OPTIMAL PERFORMANCE. It is important to identify a wall or track-light location where the output of Air/Q 210 can use, rather than fight, the natural air currents in a room.
2. Air currents in a room are determined by using a SMOKE TEST KIT available from Prolitec or any source of smoke or vapor, such as a candle or match.
3. To conduct a smoke test, stand at the entrance of the room in front of the door and observe the direction of the smoke or vapor. If the smoke drifts into the room Air/Q 210 appliance should be installed somewhere near the door.

## Installation

---

See Figure 1. If the smoke drifts out of the room, the Air/Q™ 210 appliance should be placed on the wall furthest from the door. See Figure 2. If there is no clear direction that the smoke travels or it travels upward into the air-conditioning return grill, find a position near the air-conditioning supply grill. See Figure 3.

**NOTE:** The location of Air/Q 210 MUST NOT be near an HVAC return grill, exhaust fan or vent, or an open door or window through which air is leaving the space. Remember, you want to work with the natural air flow, not against it.



Figure 1  
Smoke flows  
away from door

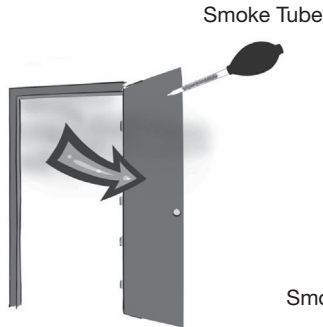

Figure 2  
Smoke flows  
back toward door



Figure 3  
Smoke travels  
toward grill

### Wall-Mounting Air/Q 210

#### **Step 1 – The Electrical Source**

Before the Air/Q 210 appliance can be mounted, a qualified electrician must install an electrical outlet at the position you have decided to place Air/Q 210. The appliance is then mounted over the outlet and plugged in.

## Installation

---

In some locations local codes or rules require that the main power source be located beside the appliance. This will require an Air/Q™ 210 hardwiring kit. If the appliance is PERMANENTLY CONNECTED in this way, a readily accessible disconnect device must be used. Consult with your electrician.

If it makes sense to plug the appliance into an outlet that is near but not behind the appliance, a rectangular, plastic wire-concealment conduit should be used.

### **Step 2 – Mounting Kit, Parts and Tools**

The mounting kit provided with Air/Q 210 (see details on pages 3-4) includes a mounting plate, which holds the appliance to the wall, and 4 screws and wall anchors suitable for plastered drywall — 2 short flat-head screws and 2 longer round-head screws. If you have another surface you will need to get anchors suitable for the wall material and screws that work with these anchors. The screws need to be the same length as the ones provided — 2 long round-head screws and 2 short flat-head screws. You will need the following tools:



1. A good level to help you make the mounting plate exactly horizontal.
2. A hammer.
3. A Phillips screwdriver to match the screws provided or whatever screwdriver matches the screws needed to attach to the anchors you have chosen.
4. A pointy tool like a small screwdriver to insert through the holes on the appliance to mark the right spot for the anchors.
5. A Drill.

## Installation

---

### ***Step 3 – Position the Mounting Bracket***

Place the mounting bracket directly over the power outlet (if hardwired or plugged elsewhere, position the mounting bracket to the side of the power source). Use the level to make sure the mounting bracket is horizontal. While holding the bracket level, use a pointy tool, screw or screwdriver to mark the location of the top two wall anchors. Check again with the level to ensure the bracket is horizontal.



## Installation

---

### ***Step 4 – Installing the Top Anchors***

Set the mounting bracket aside. Use an electric drill to make a  $\frac{1}{8}$ " hole at the exact location you marked. This will serve as a guide for the anchors. Use a hammer to tap the anchors in far enough so they stay well in position. Then screw them straight into the drywall. Avoid screwing them in at an angle.



**Hint:** If you use an electric drill with a Phillips driver head, make sure that the head fits the anchor perfectly, as the anchor strips easily. Set the drill to a slow rotation.

### ***Step 5 – Marking the Bottom Anchor Holes***

Now you can mark the holes for the bottom anchors using the mounting bracket as a template. Hold the mounting bracket in place and screw the flat-head screws half way into the top anchors. This will prevent the bracket from moving. Now use the pointy tool to mark the location for the two bottom anchors. Unscrew the top screws and set the bracket aside.

## Installation

---

### ***Step 6 – Drilling the Bottom Anchor Holes***

Drill a  $\frac{1}{8}$ " hole as the guide for the anchors at the exact spot you have marked. Hammer the anchors in just enough to set them in place, then screw them in straight.

### ***Step 7 – Hanging the Mounting Bracket***

Hang the mounting bracket by holding the bracket so the top holes match up with the anchors, then screw the 2 flat-head screws through the hole in the bracket into the anchors. Tighten the screws firmly, but do not crack the bracket.

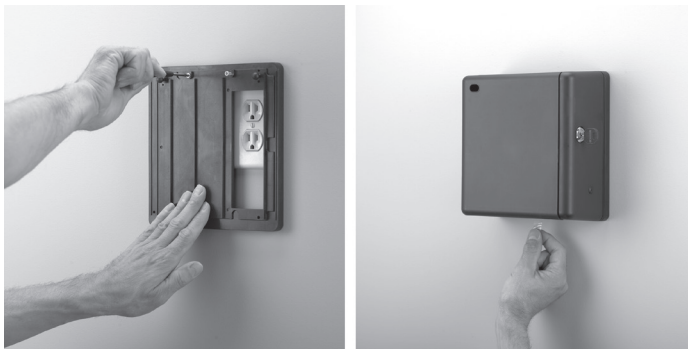

### ***Step 8 – Positioning the Appliance***

Now take the appliance and pull out the yellow tab at the bottom.

Take the power supply and plug the round plug into the hole that is located in the recess on the back of the appliance. The power-supply block can accommodate several different plugs for every county. Install the correct one and plug it into the wall receptacle.

## Installation

---

**NOTE:** Remember that the standard installation is to position the appliance right over the power source, storing the power-supply block and the power cord in the recess in the back of the appliance (US version only). To make this easy, do not untie the power cord and take just enough wire to make the connection.

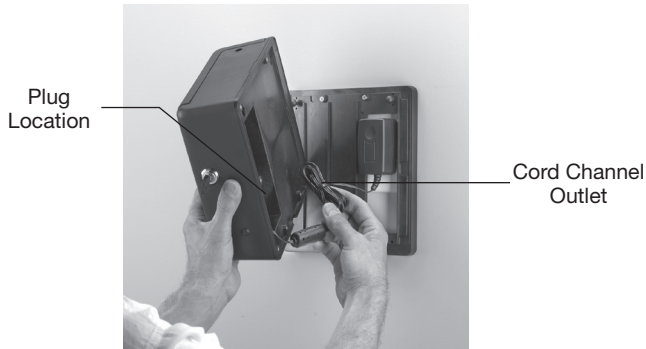

### ***Step 9 – Fitting the Appliance in Place***

Place the appliance so that the big holes in the top of the back cover fit over the rounded locking posts. In doing this, make sure the appliance is flush with the wall and the posts are in the holes of the appliance. Slide the appliance downward to lock on the posts. Sometimes this slide requires a slight tap on the top of the appliance with your hand.

## Installation

---



### ***Step 10 – Mounting the Appliance in Place***

Now unlock and open the door and insert the long round-head screws into the holes in the lower corners and into the anchors. Tighten the screws firmly.





# Starting Up

---

## Features and Controls

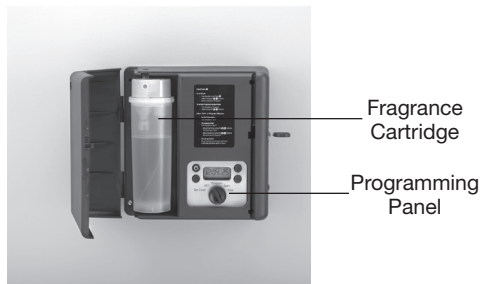
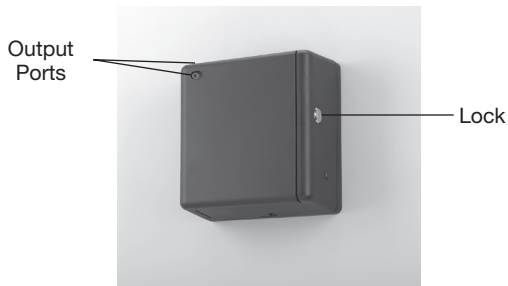

## Starting Up

---

### Setting Up the Cartridge

1. Use the key to unlock and open the door.
2. Prepare the cartridge.
  - Remove the big plug from the air-intake port (a) on the flat surface (back side) of the top of the cartridge.
  - Remove the plug from the top port (b) of the cartridge.



- **NOTE:** FRONT Output Port must remain plugged for the cartridge to operate.

## Starting Up

---

3. Insert the cartridge into the recess so that the air-intake port fits over the white air stem.



4. After inserting the cartridge, insert the 1-inch plastic tube into the cartridge through the port on the top of the appliance. (Remove tube when changing cartridge.)



## Starting Up

---

5. If the appliance has been previously programmed (see *Programming the Appliance* below), simply press the power button, close and lock the door.

### Programming the Appliance

1. Unlock and open the door.
2. Turn on the power by pressing the ON/OFF button in the upper left corner of the control panel.
3. Set the Clock.
  - Turn the dial to Set Clock. The time will blink.
  - Adjust the time forward or backward using the +/- buttons on the right side of the control panel. AM or PM is indicated on the lower right side of the time digits.
4. 24/7 Mode.
  - If you want Air/Q™ 210 to run continuously — 7 days a week, 24 hours a day — turn the dial to 24/7. If not, skip to Step 5.
5. Set specific Start/Stop Times.
  - Turn the dial to Start.
  - Adjust the clock to the time you want the appliance to start each day using the +/- keys.
  - Turn the dial to Stop.
  - Adjust the clock to the time you want the appliance to stop each day using the +/- keys.
  - Turn the dial to Program.

### Setting Scent Intensity

1. Determine the approximate size of the room in cubic feet or cubic meters by multiplying length x width x ceiling height.

## Starting Up

---

2. Consult the Room-Size Table on page 7 to give you a level (1 to 50). THIS IS ONLY A STARTING POINT.
3. Press the power button on. Turn the dial to Program and set the intensity level with the +/- keys. You will see the level numbers (1 to 50) on the right side of the screen.

**Hint:** There are many variables involved in finding the scent level that works. These include size, airflow, number of fresh air changes per hour and, most of all, user preferences. Experiment with different levels until you are completely satisfied.

## Scent Control

If you followed the Room-Size Chart, you have set Air/Q™ 210 to the low end of the range for your room size. If after 30 minutes you feel the scent is not detectable, increase the setting by about 10%. For example, if your start setting was 20, increase it by 10%, or to setting 22. Keep increasing until you and others in the space can detect a slight scent throughout the space.

## The Last Step

1. Set the dial to either 24/7 or Program if you have programmed a start/stop time.
2. Make sure the power is on. The blue light will show through the button.
3. Close and lock the door, storing the key in a known place.

## Maintenance

---

### Cartridge Change

When the reservoir is empty the cartridge needs to be changed. As noted in the Installation section, it is best to install the number of Air/Q 210s so that, at the setting they need to run to adequately treat the space, the cartridge will last for the number of days between planned services. The change process is simple.

*Always wear gloves when manipulating the cartridge.*

1. Unlock and open the door.
2. Turn off the power by pressing the power button. The blue light will go off.
3. Remove the plastic tubing.
4. Slip the short section of the removal tool (provided) in behind the top section of the cartridge. Hold the cartridge with the right hand. Push the long end backward, snapping out the cartridge. **DO NOT TRY TO REMOVE CARTRIDGE WITHOUT THIS TOOL.** There is a removal tool packed with each appliance. If you lose it, a small nail removal claw or utility tool will also work. (See photo.)



## Maintenance

---

5. Inspect the o-rings on the air stem for breakage or deterioration. Replace as needed.
6. Remove the large plug and the plug from the Output Port you wish to use (top or front), insert the new cartridge and replace the top blue tube or the front output shroud if you are using them.
7. Place the exhausted cartridge in the recycle bin.

### Cartridge Change Maintenance Checklist Items

- Cartridge plume: Use a high-intensity flashlight or your headlamp to confirm that a plume is streaming from the output port. If there is no plume:
- Check that the other output port is plugged. It should be.
- Check that the power is on and the appliance is running.
- Check that the o-rings on the air stem are in place and not cracked or broken. Replace if necessary.
- If the dial is set to Program, switch it to 24/7 and check for a plume.
- If no plume, set the dial back to Program and change the cartridge.
- If still no plume, try another cartridge just to make sure. If no plume, replace the appliance. (See *Changing an Appliance* below).
- Wipe the unit clean inside and out.

### Changing an Appliance

Appliance malfunctions are not intended to be serviced in the field. If there is no plume after following the procedure outlined above or there is any excessive noise level, then the appliance must be replaced with a new one.

1. Open the door.
2. Using a Phillips screwdriver, unscrew the two bottom screws on the lower left and right corners.

## Maintenance

---

3. Keeping the appliance flush with the wall, slide it up to unlock the top holders and remove the appliance. Leave the mounting bracket in place.
4. Install a new appliance by reversing Step 3.

### General Care

- Air/Q™ 210 is an electronic appliance. Treat it like a laptop.
- Do not place or store Air/Q 210 or its cartridges in extreme heat (more than 130° F) or in freezing temperatures.
- Do not drop Air/Q 210 on the floor. Do not drop it in or position it near water.
- Do not paint or otherwise try to alter the color of the outer cover. Air/Q 210 is available in any color.
- When shipping, pack in the original box and place it in an outer cardboard box.
- Always keep the plugs in cartridges when not in use.
- Always remove the cartridge before transporting the appliance.



## **Applications**

---

Air/Q™ 210 is used to enhance indoor air quality by neutralizing odors or introducing and maintaining a scent in the air or both at the same time. This is accomplished by blending ultra-low concentrations of odor neutralizers and fragrance ingredients (“Air-Treatment Agents”) to blend into the air. In fact, Air/Q 210 is fully effective with air concentrations of Air-Treatment Agents less than 1 part per million (ppm). This means that for every 1,000,000 molecules there is only 1 molecule of Air-Treatment Agent.

There are four basic applications for Air/Q 210: ambient scenting, scent media, odor control and aromatherapy. These applications are different in terms of their objectives, but they all employ the same combination of Prolitec’s proprietary air-treatment chemistry and Air/Q 210 computer-controlled delivery system.

### **Ambient Scenting**

Ambient Scenting is the use of a scent alongside other design elements in a space to help create or enhance its ambience. In this application, scent is comparable to visual elements such as graphics, colors, materials, textures and shapes as well as auditory elements like music. With ambient scenting, a carefully selected fragrance is used to enhance themes, animate visuals, make a tree or a flower smell like a tree or a flower, and many other uses. Major brands are using scent to extend and animate their brand by associating a scent experience with a brand, like a hotel chain using ambient scenting to make all their lobbies smell like the same scent.

Indoor air quality and the overall ambience of a space can be substantially improved with the introduction of a pleasant scent. Scent can cause humans to recall a brand with positive feelings and communicate brand values. Scent can create inviting environments that attract retail customers and cause them to stay longer and shop more, improve employee productivity, and make all the occupants feel positive about their experience in the space.

## **Applications**

---

Of all the senses, the sense of smell is the most powerful trigger of memory. Hotels, casinos, retail establishments and other businesses seeking to provide a positive experience that clients will recall and repeat should use scents to enhance indoor air quality. The use of a signature scent to extend the brand image is a powerful tool for the sophisticated marketer.

Typical areas where Ambient Scenting is used:

- Retail Stores
- Hotel Lobbies
- Malls
- Showrooms
- Clubs and Bars

### **Scent Media**

Scent Media is Prolitec's name for the use of scent as a medium of communication in advertising and promotion of certain products for which scent is a primary element or feature. Presenting the scent of a scented product to customers at the point of sale is the most powerful way to sell any product with a scent including fine fragrances; soaps, detergents and fabric softeners; lotions and potions; scented health and beauty aids; food products like coffee, fruits, and baked goods; and other fresh and aromatic products.

Air/Q™ 210 is used as an automated presentation and product-sampling system to deliver the exact aroma of a scented product throughout a store or at the point of sale.

For example, enabling the client to experience a fine fragrance, personal care or home fragrance is the most effective way to sell it. Scent is the main feature of these products. Using Air/Q 210 to present that scent to a customer is the best way to present and sell the product. In this way, Air/Q 210 delivers a true and complete experience of the scent to clients and passersby without intrusion or sales associate intervention.

## Applications

---

Billboards and advertising panels can be equipped with Air/Q™ 210 to treat the surrounding air space with the scent that is being advertised on the billboard. This is particularly effective in high-traffic areas such as malls, airports and train and subway stations. This is a multi-sensorial approach that draws customers to the display while simultaneously enhancing the visuals and allowing the prospective customer to experience or “sample” the scent of the product.

### Odor Control

One of the most challenging problems in indoor air quality is bad odors. Bad-smelling places have a negative emotional impact on all the occupants of the space. This means both employees and customers.

Air/Q 210 and Prolitec’s proprietary odor-remediation chemistry are capable of blocking the human ability to detect most malodors and replacing these odors with pleasant scents. Prolitec’s proprietary air-treatment chemistry and the accompanying computer-controlled delivery system are rapidly becoming the standard solution for difficult odor issues in several industry sectors.

Typical problem areas that can be addressed by Air/Q 210 include:

- Restrooms
- Garbage-compaction areas
- Areas adjacent to cooking and food preparation
- Swimming pools and adjacent areas
- Workout facilities
- Elevator shafts
- Hotel hallways

## Applications

---

The Prolitec approach to odor remediation uses a proprietary and patented neutralizer that inhibits the human olfactory system from detecting the odor and then injecting a small amount of scent to create an ultra-low concentration in the air of less than 1 ppm. This approach is unique and much more effective than traditional approaches that simply douse the odor with a high concentration of scent.

### **Aromatherapy and Performance Scenting**

It is well known that scent has a powerful impact on human emotion and behavior. The use of scent to influence human emotion is just like Ambient Scenting but with a specific objective for the occupants of the treated space. The use of scent and the essential oils of flowers, herbs and trees to promote health and well being is the well-established branch of alternative medicine known as aromatherapy. It is also recognized that scent can be used to optimize performance in the workplace. The benefits include reduced errors in routine functions, increased employee sense of well being, higher morale, improved customer service and overall improved productivity.

Air/Q 210™ and Prolitec aromatherapy chemistry can help make a workspace a more comfortable and appealing place to be.

As examples of the positive effect of aromatherapy on the workplace, below are results of several relevant studies:

- A 1991 study demonstrated that “sustained attention tasks” were performed with greater accuracy by the participants in scented rooms compared to those in the non-scented control rooms.<sup>1</sup>
- Another study found that fragrance had a dramatic and positive effect on a proofreader’s efficiency.<sup>2</sup>
- It is commonly known that the Tokyo Stock Exchange diffuses peppermint into the air in the afternoons to make the brokers feel invigorated.

---

<sup>1</sup> Dr. Joel Warm and Dr. William Dembar. “Olfactory Stimulation and Sustained Attention.” Compendium of Olfactory Research, (Dubuque, Iowa: Kendall/Hunt Publishing Co., 1995) p. 47.

<sup>2</sup> Mark Kilauga et al. “Consumer Panel Study on the Effect of Peppermint and Lavender Fragrances on Proofreading.” Compendium of Olfactory Research, (Dubuque, Iowa: Kendall/Hunt Publishing Co., 1995) p. 131.

## Precautions

---

### Appliance Precautions:

- DO NOT position Air/Q within the reach of young children or pets.
- The appliance must be operated in an upright or vertical position and firmly attached to a vertical surface such as a wall or a duct.
- The appliance should NOT be used with the door in the open position. The door is opened only to perform a cartridge or program change.
- NEVER put your nose to the output of Air/Q. Within 12 inches of the output, the fragrance is highly concentrated. The improper inhalation of high concentrations of fragrance may cause irritation including watery eyes, headache, cough and upper respiratory discomfort.
- The appliance is built to be plugged into an 110VAC or 220VAC power outlet. Must be used only with the approved and included power supply. The UL and CE compliant power supply converts power to 12V DC to power the appliance.
- Unplug before cleaning.
- For online safety instructions, visit [www.prolitec.com/manuals/manuals.htm](http://www.prolitec.com/manuals/manuals.htm)

### Fragrance Cartridge Precautions

- Read the Consumer Product Safety Information Sheet and the Material Safety Data Sheet provided with each shipment of Cartridges. Insure that these information sheets are available for review by employees.
- Use latex gloves to handle a Cartridge to avoid the liquid getting on hands. The Air/Q fragrances are formulated so as to not be harmful in contact with the skin, but the concentrated nature of the fragrances may make the scent difficult to remove from hands and skin.
- Wash your hands after all contact with Cartridges or fragrance.
- Cartridges must be provided by and contain formulations which have been manufactured and certified by Prolitec.

## Precautions

---

- While Air/Q Air Treatment Agents do not contain ingredients deemed harmful to the skin, if there is skin contact, wash with soap and water. If there is contact with the eyes, irrigate the eye with fresh water for 5 minutes. If there is any eye irritation, consult a physician immediately.

## Frequently Asked Questions (FAQs)

---

### **How does Air/Q 210 work?**

Air/Q 210 uses a recently patented technology to convert liquid fragrance compounds into tiny droplets less than  $\frac{1}{100\text{th}}$  the diameter of a human hair. By comparison, an aerosol droplet is 100 times bigger and 1,000,000 times heavier. Air/Q 210 droplets present 100 times more surface area to the air being treated, which means much less fragrance is used to create the scent effect. Air/Q 210's tiny droplets are extremely light so they float easily into the air and disperse throughout a space to create an even scent effect.

### **What size room will Air/Q 210 handle?**

Air/Q 210 is fully adjustable for different size rooms. Air/Q 210 is effective in spaces from 200 to 30,000 cubic feet (10 to 850 cubic meters). The cubic measure is width x length x ceiling height.

### **Where can I place Air/Q 210?**

You must place Air/Q 210 on a wall where it can take full advantage of the natural air currents in the space as determined by a smoke test or as known by you.

### **Do I need to adjust Air/Q 210?**

Yes! Air/Q 210 is a powerful machine. Air/Q 210 can handle small and very large rooms. If it is set too high for the room size, it can cause discomfort for some people. Adjusting is simple. Take the time to do it right.

## Frequently Asked Questions (FAQs)

---

### **How do I adjust Air/Q™ 210?**

With the power cord plugged in you can adjust Air/Q 210 up and down using the +/- buttons just to the right of the LCD screen. You can see the setting levels (1 to 50) on the right side of the LCD. ALWAYS START WITH THE RECOMMENDED SETTING and adjust upward in small steps.

### **How strong should I make the scent?**

Less is more. Air/Q 210 allows you to erase odors and use only a small amount of scent. Unlike most other air fresheners, Air/Q 210 is adjustable. Use this important feature. Always start on the lowest settings for the size of the space then adjust upward in small steps.

#### **IMPORTANT**

ALLOW 30 MINUTES TO ASSESS the scent strength after starting or adjusting. It is best to assess strength when you first enter the room from another room.

### **How about safety? Is Air/Q 210 safe to use with children and pets?**

When used as directed, Air/Q 210 is the safest air freshener available. Of course, it is important to read the Material Safety Data Sheets enclosed with each cartridge, which should be stored in a secure, visible location.

### **How does Air/Q 210 differ from aerosol room fresheners?**

The more expensive aerosols can produce a very pleasant scent, but only for a few minutes and in very high concentrations just in the area they were sprayed. Air/Q 210 is what is known as a “continuous action” air freshener. Air/Q 210 is always on and delivers an evenly distributed scent throughout the room.

## Frequently Asked Questions (FAQs)

---

### **Is Air/Q™ 210 eco-friendly?**

Yes, Air/Q 210 is the most eco-friendly air freshener on the market. Unlike aerosols, Air/Q 210 uses no propellants and produces no harmful volatile organic compounds, or VOCs. Unlike many air fresheners, Air/Q 210 uses no ethanol or similar solvents to enhance the evaporation of fragrance chemicals.

### **I only want to scent the room at certain times. Do I have to turn it on and off every time?**

Air/Q 210 has a tiny on-board computer for fully automatic operations. You can set the time to start and the time to stop each day. (See *Programming the Appliance* on page 18.)

### **What if I just want to scent for brief periods?**

No problem. There is a single button just below the On/Off switch that you can press to turn Air/Q 210 ON for a set number of hours. You can set the number of hours you wish. (See *Programming the Appliance* on page 18.)

### **IMPORTANT**

Always keep the caps or lids on cartridges when not in use. If you have misplaced the caps from the cartridge being removed from Air/Q 210, you can use the caps from the new cartridge being inserted.

### **If I want a different scent, can I switch cartridges?**

Yes, simply remove the cartridge and replace it with another. When not in use, remember to replace the caps on the cartridge openings so the fragrance doesn't drip, evaporate or change while out of Air/Q 210.

### **Will Air/Q 210 leave deposits on furniture or carpeting?**

No, provided you do not direct the output at a surface closer than 12 inches away.



## Frequently Asked Questions (FAQs)

---

### **Will Air/Q™ 210 fragrances stain surfaces or fabric?**

Yes, all air-care fragrances will stain wood and stone and all fabrics if spilled. The best solution is avoidance by replacing the caps on cartridges after removing them and keeping the caps on all cartridges when not in use.

### **How do I clean up a drip?**

If there is a drip, blot it as quickly as possible and then clean with soap and water.

## Specifications

---

**Dimensions:** Air/Q 210 Appliance 8<sup>5</sup>/<sub>8</sub>" x 8<sup>6</sup>/<sub>8</sub>" x 3<sup>7</sup>/<sub>8</sub>" (21.9 cm x 22.2 cm x 9.8 cm)

**Weight:** 4.7 lbs (2.2 kg) with full cartridge

**Power Supply:** Input — 100 – 240 VAC at 0.6A

Frequency — 50/60 Hz

Protection — Switching power supply

Internal Power — 15 VDC at 1 A

Battery — Lithium 3V, #CR2032

**Approvals:** FCC part 15, CE & RoHS Compliant, UL Power Supply

**Working Temperature:** 0° to 40° C

**Working Humidity:** 85% or less

**Liquid Capacity:** 175 ml Cartridges

**Service Area:** Up to 15,000 cu. ft. (424 m<sup>3</sup>) served

Part No. 8530

Prolitec, Incorporated  
1235 Canal Street  
Milwaukee, WI 53223-1667  
1-866-387-4333  
[www.prolitec.com](http://www.prolitec.com)